

MACLAY GARDENS 5K COURSE

[Not Drawn to Scale]

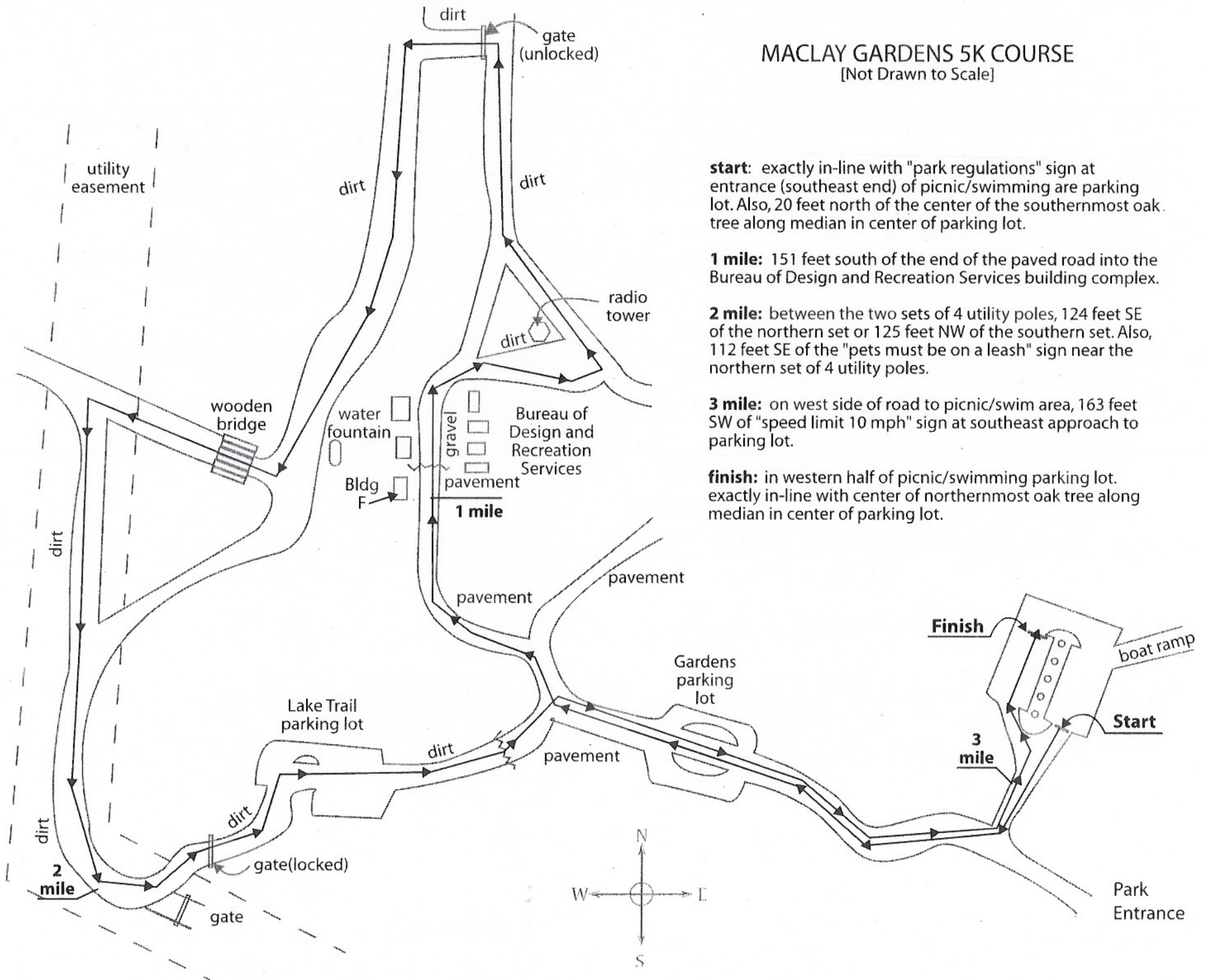

start: exactly in-line with "park regulations" sign at entrance (southeast end) of picnic/swimming are parking lot. Also, 20 feet north of the center of the southernmost oak tree along median in center of parking lot.

1 mile: 151 feet south of the end of the paved road into the Bureau of Design and Recreation Services building complex.

2 mile: between the two sets of 4 utility poles, 124 feet SE of the northern set or 125 feet NW of the southern set. Also, 112 feet SE of the "pets must be on a leash" sign near the northern set of 4 utility poles.

3 mile: on west side of road to picnic/swim area, 163 feet SW of "speed limit 10 mph" sign at southeast approach to parking lot.

finish: in western half of picnic/swimming parking lot. exactly in-line with center of northernmost oak tree along median in center of parking lot.